

**Lubrication plan**

Fig. 211



Position	Lubrication point	Interval	Quantity
1.	Bucket cylinder	Daily	2
2.	Stick cylinder	Daily	2
3.	Boom cylinder	Daily	2
4.	Boom	Daily	2
5.	Swiveling cylinder	Daily	2
6.	Stabilizer blade	Daily	4
7.	Shovel arm	Daily	3
8.	Joint rod	Daily	1
9.	Swiveling console	Daily	2
10.	Ball bearing race	Every week	1
11.	Hydraulic quickhitch (option)	Daily	4

## Control lever base

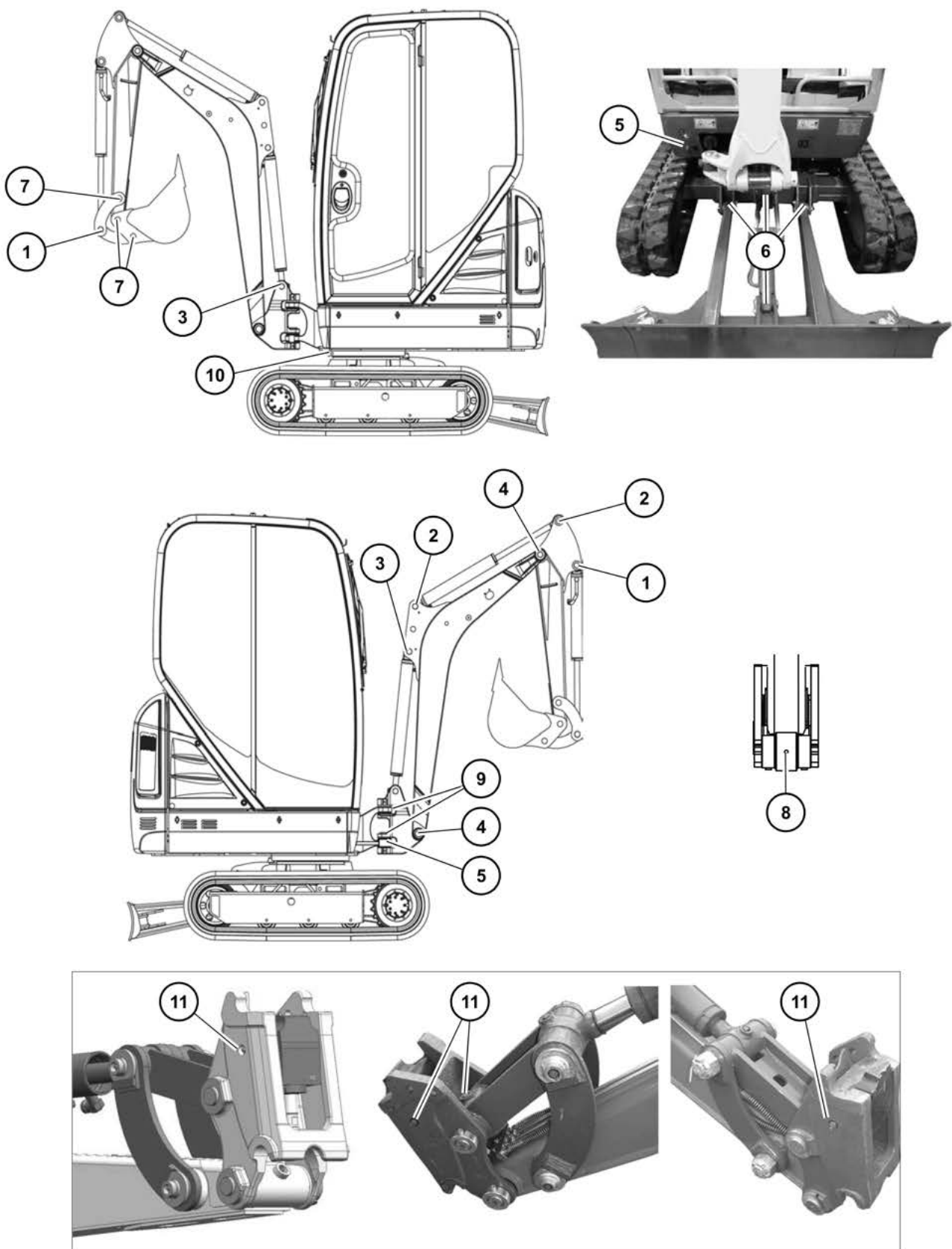

### CAUTION

Crushing hazard in the area of the moving parts of the control lever base.

There is a risk of injury in the area of the moving parts.

► Stay clear (extremities, clothing) of the moving parts.

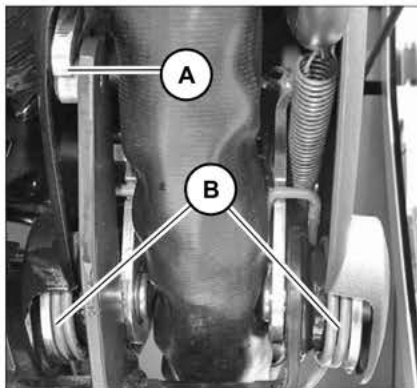

Fig. 212

1. Stop and park the machine. Stop the engine. See "Preparing lubrication".
2. Raise the control lever base.
3. Spray the guide lever **A** and springs **B** with semi-fluid grease.
4. Raise and lower the control lever base several times.



### Information

Keep the lubrication points clean and remove any escaping grease.

## Live ring (ball bearing)

### **DANGER**

#### **Danger of crushing when lubricating the ball bearing race!**

Serious crushing danger causing death or serious injury!

- ▶ Park the machine as shown in [Fig. 210](#).
- ▶ Do not rotate the upper carriage.

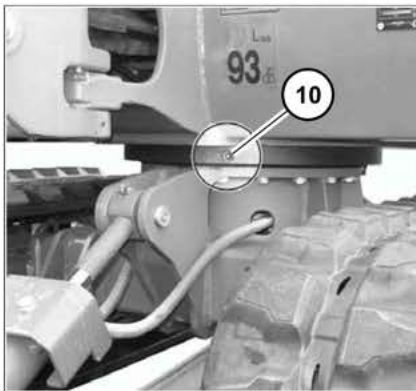

Fig. 213

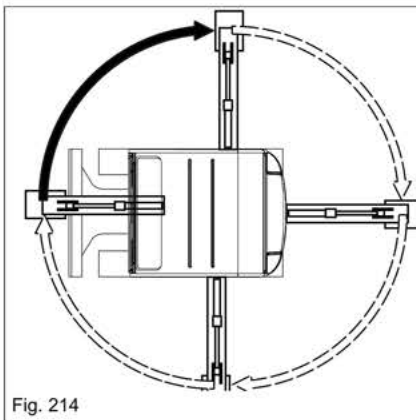

Fig. 214

1. Park the vehicle on firm, level, and horizontal ground.
2. Lower the boom and the stabilizer blade to the ground.
3. Stop the engine, remove the starting key and carry it with you.
4. Apply grease to lubrication point **10** with two strokes of the grease press.
5. Start the engine, raise the boom and the stabilizer blade.
6. Rotate the upper carriage by 90°.
7. Repeat steps 2-6 three times until the revolving superstructure is back in its initial position.
8. Rotate the upper carriage several times by 360°.

### **Information**

Keep the lubrication points clean and remove any escaping grease.

## Teeth of live ring

The live ring gear is maintenance-free.